

MANGALMURTI

PLOT NO. 384, SECTOR-17, ULWE

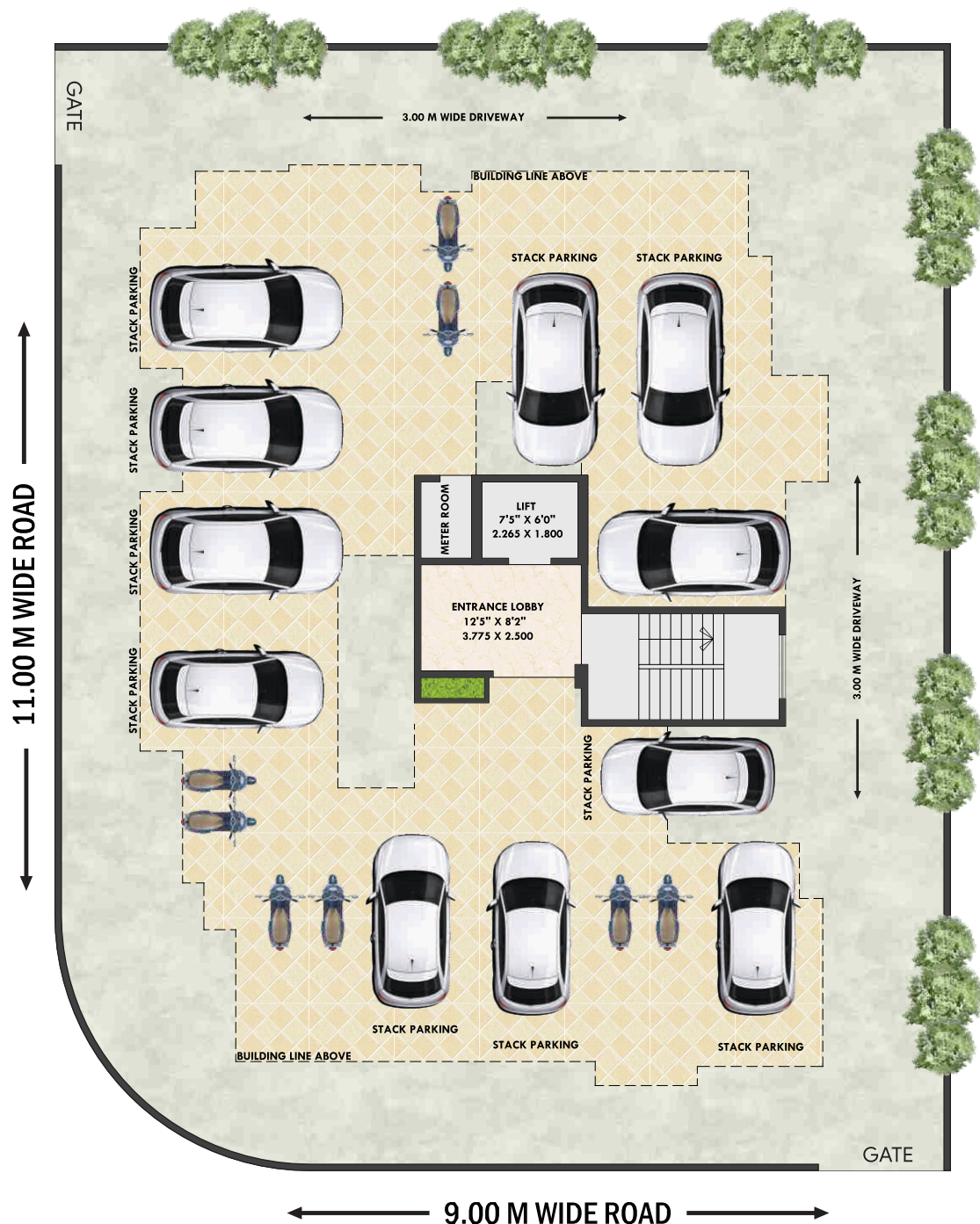

GROUND FLOOR PLAN



Amenities

- Designer Vitrified 48"x 24" Tiles Flooring.
- Designer Digital Wall Tiles in W/C, Bath Room & Kitchen.
- Bathroom Fittings of Reputed Brands.
- Kitchen Platform with Granite Top and Stainless Steel Sink.
- Decorative Laminated Main Doors with wooden frame.
- Aluminum Louvered / Powder Coated Sliding Windows.
- Concealed Electrical Copper Wiring (ISI) with Circuit Breakers.
- Modular Switches of Reputed make.
- Adequate electrical points in each room.
- Double Coat Plaster and Acrylic Paint on External Walls & Emulsion Paint on Internal Walls.
- Brickbat water proofing treatment for Terrace.
- Underground & Overhead Water Tank.

TYPICAL FLOOR PLAN

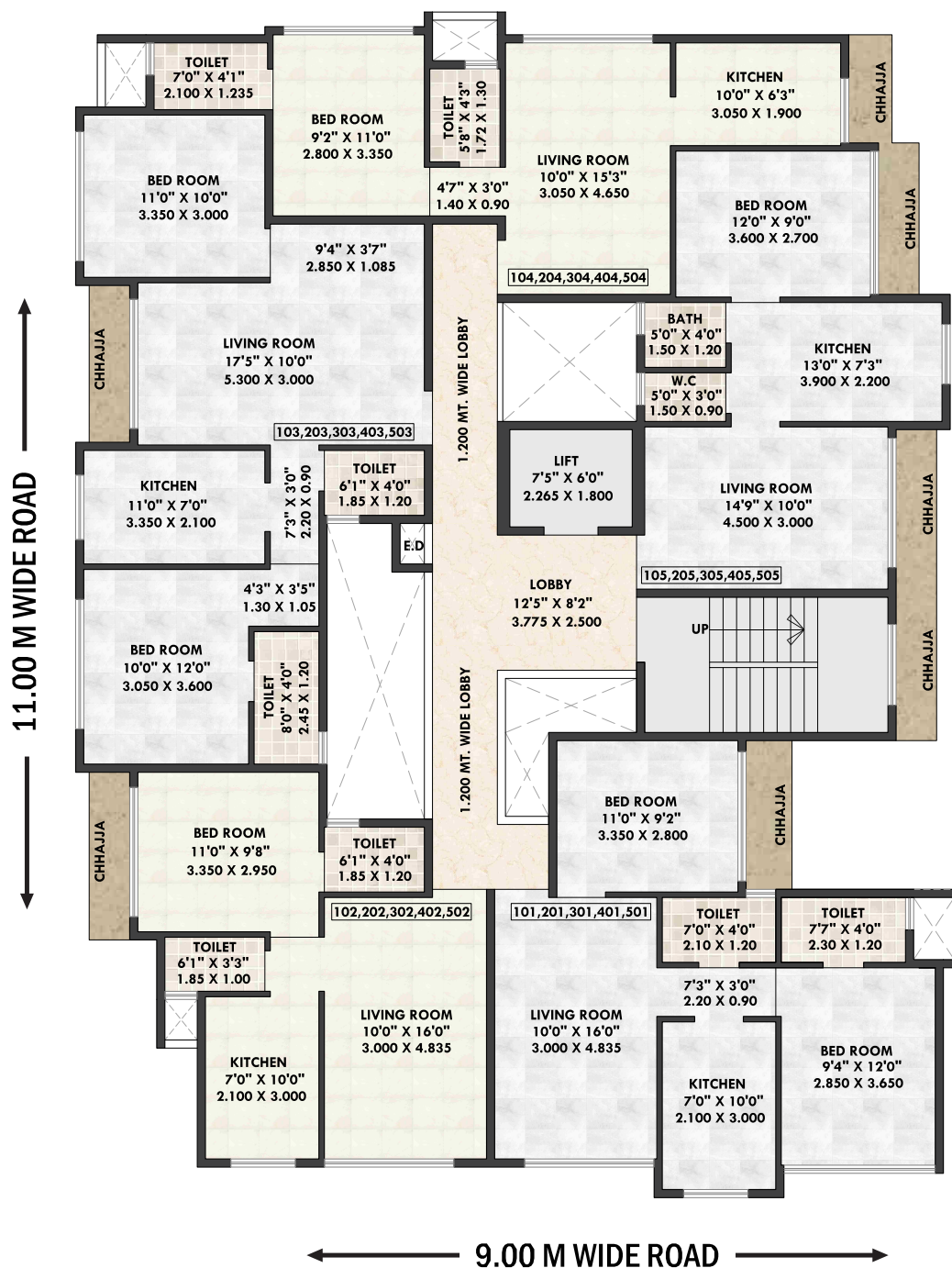

Project Features

- Clear Title CIDCO Trasfer Plot
- G+6 Storey Pure Residential Building
- 1 BHK, 2 BHK & 3 BHK Flats
- Attractively Designed Entrance Lobby
- Earthquake Resistant RCC Design
- Fully automatic high speed Elevator
- Loans Available from major Banks & Financial Institutions.

Location Features

- 5 mins from Kharkopar Railway Station.
- 3 mins from Ramsheth Thakur International Sports Complex.
- 15 mins from Atal Sethu MTHL Sea Link.
- 15 mins Prop. Navi Mumbai International Airport.
- Upcoming Coastal Road.
- Easy access to Belapur, Seawoods & Vashi.
- Nearby School, Colleges & Shopping Markets,



Through the last two decades, we at GK Buildcon have provided realty solutions for people in Mumbai, Navi Mumbai, and Pune

Project By



Office Address :

61, Mahavir Center, Sector-17,
Vashi, Navi Mumbai.

Site Address:

Plot No. 384, Sector-17, Ulwe,
Navi Mumbai.



MAHARERA
P52000053791

Architect : Rajesh R.C.
RCC : CSE Consultant

FOR BOOKING CONTACT
9833976369 | 9322743594